



Bartlams

28 Beechwood Court, Corfton Drive, WV6 8PE

Offers in the Region Of £109,950

A prominently positioned first-floor apartment in a highly favoured retirement complex within a particularly pleasant setting with amenities within walking distance to Tettenhall village and Tettenhall Wood. Neatly presented accommodation, very comfortably appointed and offering independent lifestyle with the benefit of excellent communal facilities. Spacious Living Room with feature marble fireplace; Fitted Kitchen; Large master Bedroom, with wardrobes; Shower Room; Electric heating; Double glazed windows; Pleasant communal residents Lounge; House manager service and emergency call system; Leasehold; Ground rent and service charge payable; Occupancy restricted to aged 60 years plus **NO UPWARD CHAIN******

Communal Entry having Stairs and lift to First and Second floors, Communal lounge and Laundry room.

Entrance Hall with airing cupboard and storage heater.

Lounge/Diner 19' 4" x 14' 4" (5.89m x 4.37m) having window to rear, storage heater, fire place, opening into

Kitchen 7' 7" x 9' 8" (2.31m x 2.94m) a range of cream wall and base units with work surface over, single sink with drainer, electric hob, electric oven and extractor fan and tiled walls.

Bedroom 15' 8" x 8' 7" (4.77m x 2.61m) room measured to built in wardrobe. storage heater and window to rear.

Shower room Shower cubicle, WC and sink, heated towel rail and extractor fan, fully tiled walls.

Outside Off road parking is available on a first come first served basis. The property has communal gardens.

- NO CHAIN.
- OVER 60's.
- BEAUTIFUL LOCATION.
- LEASE - 89 YEARS REMAINING.
- .GROUND RENT - £247.10 HALF YEARLY.
- SERVICE CHARGE - 2490.82 PER YEAR.
 - EPC RATING - B.
 - COUNCIL TAX BAND - B.



Leasehold
COUNCIL TAX BAND - B
EPC RATING - B

NOTICE: These particulars, although believed to be correct, do not constitute any part of an offer or contract. All statements contained in these particulars as to this property are made without responsibility and are not to be relied upon as statements or representations of warranty whatsoever in relation to property. Any intending purchaser must satisfy themselves by inspection or otherwise as to the correctness each of the statements contained in these particulars. All measurements are approximate and for illustrative purposes only. Photographs are produced for general information and it must not be inferred that any item shown is included in the sale.

DISCLOSURE: As a professional Estate Agency our clients employ us to look after their best interests. This includes providing them with full details of offers made to purchase their property. To ensure our obligations to our clients are met we need to check the status of all potential purchasers. If you make an offer on this property we will ask a member of The Finance Family to contact you to verify your status. They are a leading firm of Independent Financial Advisers and Mortgage Brokers. Should they transact any business resulting from our introduction then we may receive a commission.

Bartlams



GROUND FLOOR

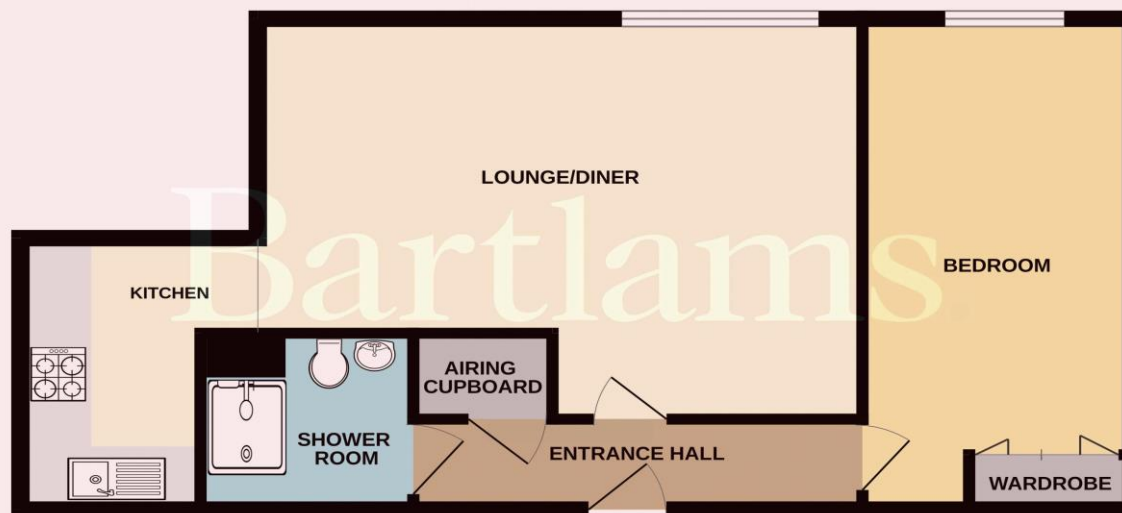

Whilst every attempt has been made to ensure the accuracy of the floorplan contained here, measurements of doors, windows, rooms and any other items are approximate and no responsibility is taken for any error, omission or mis-statement. This plan is for illustrative purposes only and should be used as such by any prospective purchaser. The services, systems and appliances shown have not been tested and no guarantee as to their operability or efficiency can be given.
Made with Metropix ©2023

PLEASE SIGN BELOW TO AGREE THAT THE DETAILS ARE ACCURATE TO THE BEST OF YOUR KNOWLEDGE

SIGNED:

DATE:

24 High Street TETTENHALL Wolverhampton West Midlands WV6 8QT

01902 759888

tettenhallsales@bartlams.co.uk

www.bartlams.co.uk



